



## Model(s) Z7000-i7

Temp-Gard® Institutional Shower Head, 2.2 GPM

TAG

### Architectural/Engineering Specification:

Ball joint solid brass chrome plated shower head, with bronze body institutional wall mount with hard chrome plated finish, maximum flow rate 2.2 gpm at 80 psi, pressure compensating flow control feature maintains constant flow rate, 1/2" NPT female threaded inlet, fixed body width spray pattern 4 mounting screws provided, vandal resistant standard.

### PRODUCT FEATURES:

- Institutional wall mount shower head
- Solid brass chrome-plated shower head with ball joint connector
- Fixed body width spray pattern
- Vandal resistant screws



*\*Although products with certain combinations of options and features will meet or comply with these standards and/or certifications, not every combination of options and features will result in such compliance. If you have any questions about your particular product, please contact our Customer Care Dept. at 1-855-ONE-ZURN (United States) or 1-877-892-5216 (Canada) for confirmation.*

Architectural/Engineering Approval

Design and dimensional data (inches and [mm]) are subject to manufacturing tolerances and change without notice.

⚠ WARNING: Cancer and Reproductive Harm – [www.P65warnings.ca.gov](http://www.P65warnings.ca.gov)  
⚠ ADVERTENCIA: Cáncer y daño reproductivo – [www.P65warnings.ca.gov](http://www.P65warnings.ca.gov)  
⚠ AVERTISSEMENT: Cancer et effets néfastes sur la reproduction – [www.P65warnings.ca.gov](http://www.P65warnings.ca.gov)

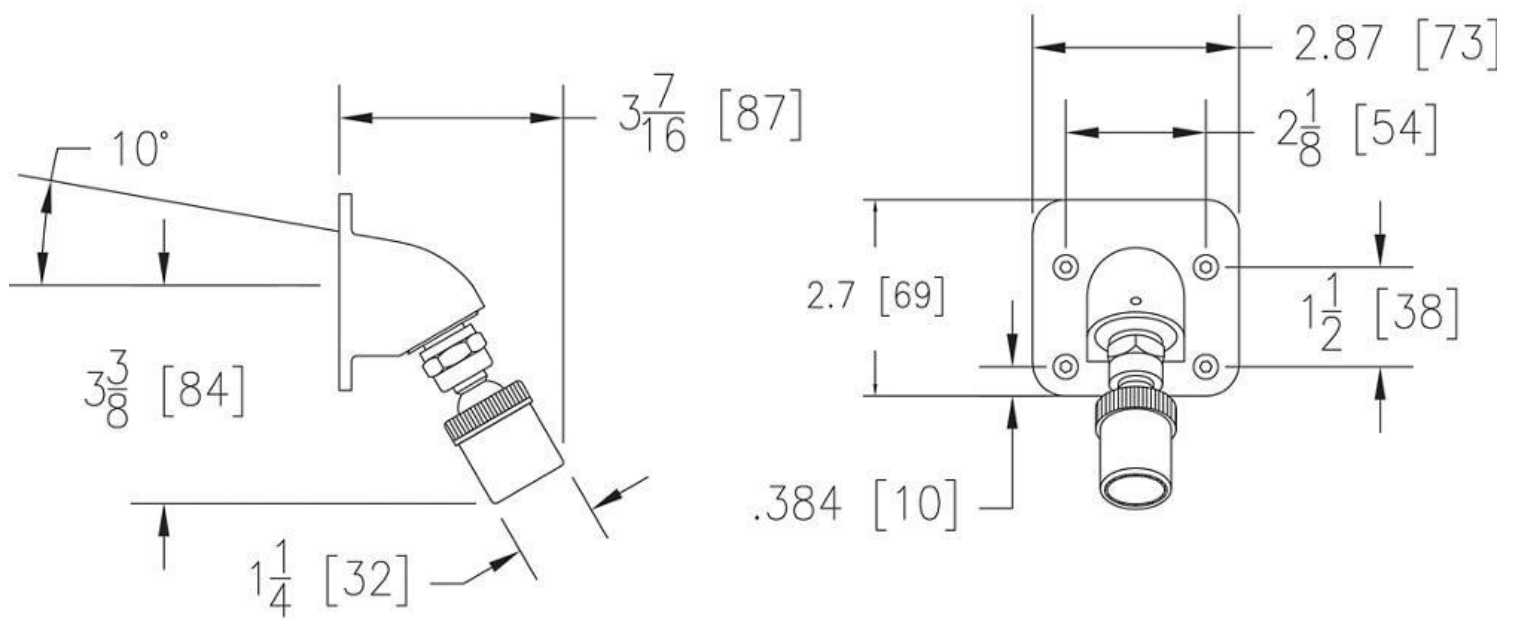

NOTE: All dimensions are for reference only. Do not use for pre-plumbing.

Design and dimensional data (inches and [mm]) are subject to manufacturing tolerances and change without notice.

⚠ WARNING: Cancer and Reproductive Harm – [www.P65warnings.ca.gov](http://www.P65warnings.ca.gov)  
 ⚠ ADVERTENCIA: Cáncer y daño reproductivo – [www.P65warnings.ca.gov](http://www.P65warnings.ca.gov)  
 ⚠ AVERTISSEMENT: Cancer et effets néfastes sur la reproduction – [www.P65warnings.ca.gov](http://www.P65warnings.ca.gov)