



Architectural/Engineering Specification:

Bronze body with hard chrome plated finish, maximum flow rate 2.5 GPM at 80 PSI, with variable flow orifice feature to maintain constant flow rate, fixed stream head, 1/2" NPT female threaded inlet, 4 mounting screws provided, vandal resistant standard, 30 degree shower head angle as standard.

FLOW OPTIONS:

-1.25	Water Saver Flow Control, 1.25 GPM
-1.5	Water Saver Flow Control, 1.5 GPM
-1.75	Water Saver Flow Control, 1.75 GPM
-2.0	Water Saver Flow Control, 2.0 GPM

SUFFIX OPTIONS:

-AP	Anchor Plate
-BP	Base Plate



Product Compliance: CEC

**Although products with certain combinations of options and features will meet or comply with these standards and/or certifications, not every combination of options and features will result in such compliance. If you have any questions about your particular product, please contact our Customer Care Dept. at 1-855-ONE-ZURN (United States) or 1-877-892-5216 (Canada) for confirmation.*

Architectural/Engineering Approval

Design and dimensional data (inches and [mm]) are subject to manufacturing tolerances and change without notice.

⚠ WARNING: Cancer and Reproductive Harm – www.P65warnings.ca.gov
⚠ ADVERTENCIA: Cáncer y daño reproductivo – www.P65warnings.ca.gov
⚠ AVERTISSEMENT: Cancer et effets néfastes sur la reproduction – www.P65warnings.ca.gov

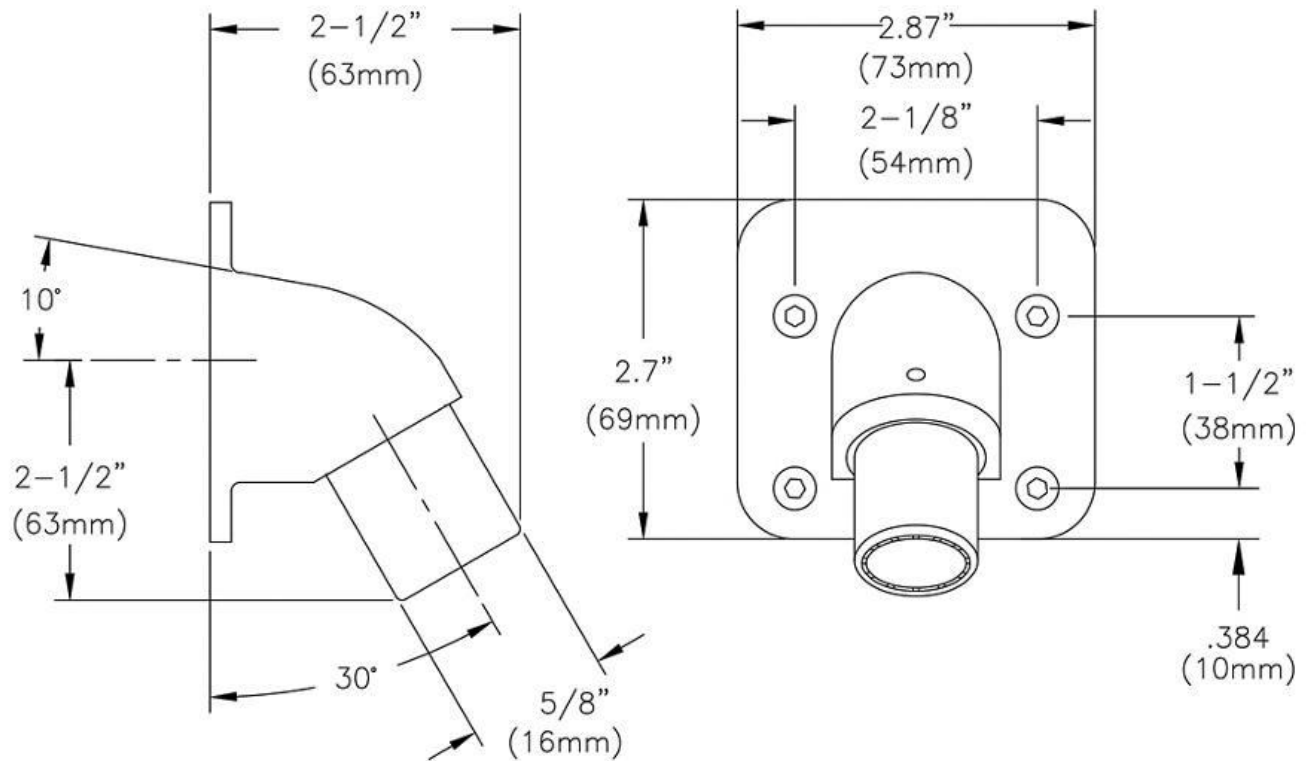

NOTE: All dimensions are for reference only. Do not use for pre-plumbing.

Design and dimensional data (inches and [mm]) are subject to manufacturing tolerances and change without notice.

⚠ WARNING: Cancer and Reproductive Harm – www.P65warnings.ca.gov
 ⚠ ADVERTENCIA: Cáncer y daño reproductivo – www.P65warnings.ca.gov
 ⚠ AVERTISSEMENT: Cancer et effets néfastes sur la reproduction – www.P65warnings.ca.gov