



## Model(s) Z6933

AquaSense® Single Hole Sensor Faucet in Chrome

TAG \_\_\_\_\_

### Architectural/Engineering Specification:

Designed for modern commercial restrooms, the AquaSense Z6933 sensor faucet delivers a superior user experience in both form and function. This faucet maintains a sleek and simple design that is easy to install and user-friendly. easy to install and user-friendly handwashing solution. This faucet has been designed and manufactured to comply with Section 1417 of the Safe Drinking Water Act (SDWA) which mandates the weighted average lead content of no more than 0.25% of the wetted surface.

### PRODUCT FEATURES:

- Infrared convergence-type proximity sensor
- 60 second time out feature
- In-line filter
- 4 "AA" batteries
- 45" sensor cable
- 24" hose

### SUFFIX OPTIONS:

|        |   |
|--------|---|
| -CP4   | Cover Plate 4" [102mm] Centers                                  |
| -MV    | Temperature Mixing Valve  |
| -SH    | Three Supply Hoses for Mixing Valve                             |
| -SSH   | Single Supply Hose  |
| -TMV-1 | Thermostatic Mixing Valve for Single Faucets (ASSE Listed 1070) |

### AERATOR OPTIONS:

|           |  | Flowrate<br>GPM [L] | Vandal-Resistant | WaterSense*<br>Labeled | Outlet Type |
|-----------|--|---------------------|------------------|------------------------|-------------|
| Suffix    |  |                     |                  |                        |             |
| -Standard |  | 1.5 GPM [5.7L]      |                  |                        |             |
| -L        |  | 1.0 GPM [3.8L]      | x                | x                      | Aerator     |



### Product Compliance:

ASME A112.18.1/CSA B125.1  
CEC  
CSA B125.1  
IPC  
NSF 61  
NSF 372  
WaterSense



\*This product should be used with a WaterSense labeled counterpart with a compatible flow volume to ensure that the entire system meets the requirements for water efficiency and performance.

*\*Although products with certain combinations of options and features will meet or comply with these standards and/or certifications, not every combination of options and features will result in such compliance. If you have any questions about your particular product, please contact our Customer Care Dept. at 1-855-ONE-ZURN (United States) or 1-877-892-5216 (Canada) for confirmation.*

[Installation Guide - FV763](#)

Architectural/Engineering Approval

Design and dimensional data (inches and [mm]) are subject to manufacturing tolerances and change without notice.

⚠ WARNING: Cancer and Reproductive Harm – [www.P65warnings.ca.gov](http://www.P65warnings.ca.gov)  
⚠ ADVERTENCIA: Cáncer y daño reproductivo – [www.P65warnings.ca.gov](http://www.P65warnings.ca.gov)  
⚠ AVERTISSEMENT: Cancer et effets néfastes sur la reproduction – [www.P65warnings.ca.gov](http://www.P65warnings.ca.gov)

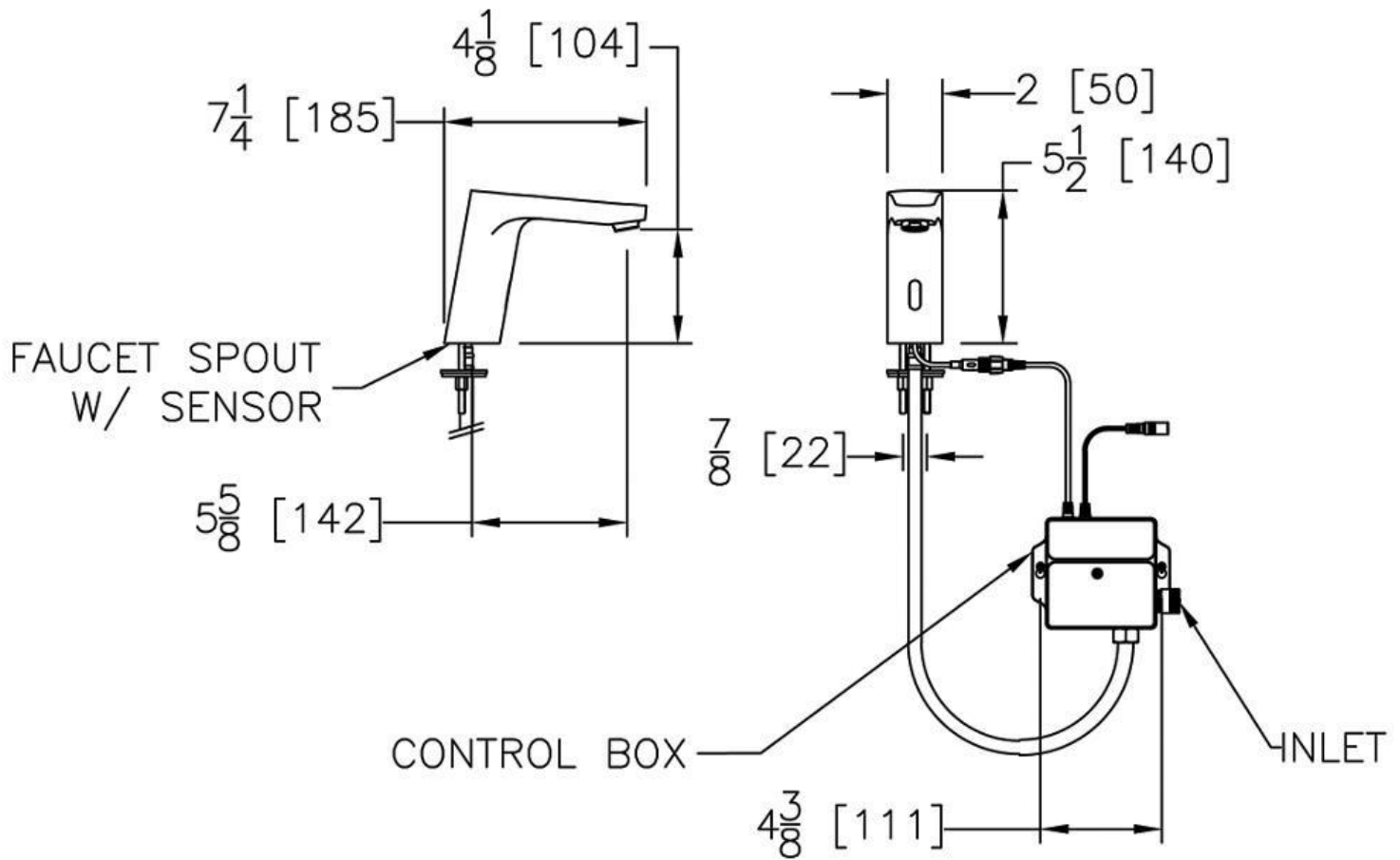

NOTE: All dimensions are for reference only. Do not use for pre-plumbing.

Design and dimensional data (inches and [mm]) are subject to manufacturing tolerances and change without notice.

⚠ WARNING: Cancer and Reproductive Harm – [www.P65warnings.ca.gov](http://www.P65warnings.ca.gov)  
 ⚠ ADVERTENCIA: Cáncer y daño reproductivo – [www.P65warnings.ca.gov](http://www.P65warnings.ca.gov)  
 ⚠ AVERTISSEMENT: Cancer et effets néfastes sur la reproduction – [www.P65warnings.ca.gov](http://www.P65warnings.ca.gov)