



Model(s) Z6199

Z6199 Aquaflush® Access Panel and Frame

TAG

Architectural/Engineering Specification:

The access panel and frame provide quick and simple access to in-wall concealed flush valves when a mechanical chase of adequate size is not available.

PRODUCT FEATURES:

- Cover #14 gage stainless steel satin finish
- Frame #18 gage stainless steel satin finish
- For 12 x 12, and 15 x 15 panels (4) 1"[25] long vandal proof screws
- For 13 x 17 panels (6) 1"[25] long vandal proof screw

SUFFIX OPTIONS:

<input type="checkbox"/>	-NH	Solid Panel
<input type="checkbox"/>	-SC-2	2" [51mm] Long Vandal Proof Screws



**Although products with certain combinations of options and features will meet or comply with these standards and/or certifications, not every combination of options and features will result in such compliance. If you have any questions about your particular product, please contact our Customer Care Dept. at 1-855-ONE-ZURN (United States) or 1-877-892-5216 (Canada) for confirmation.*

[Installation Guide - FV212.pdf](#)

Architectural/Engineering Approval

Design and dimensional data (inches and [mm]) are subject to manufacturing tolerances and change without notice.

⚠ WARNING: Cancer and Reproductive Harm – www.P65warnings.ca.gov
⚠ ADVERTENCIA: Cáncer y daño reproductivo – www.P65warnings.ca.gov
⚠ AVERTISSEMENT: Cancer et effets néfastes sur la reproduction – www.P65warnings.ca.gov

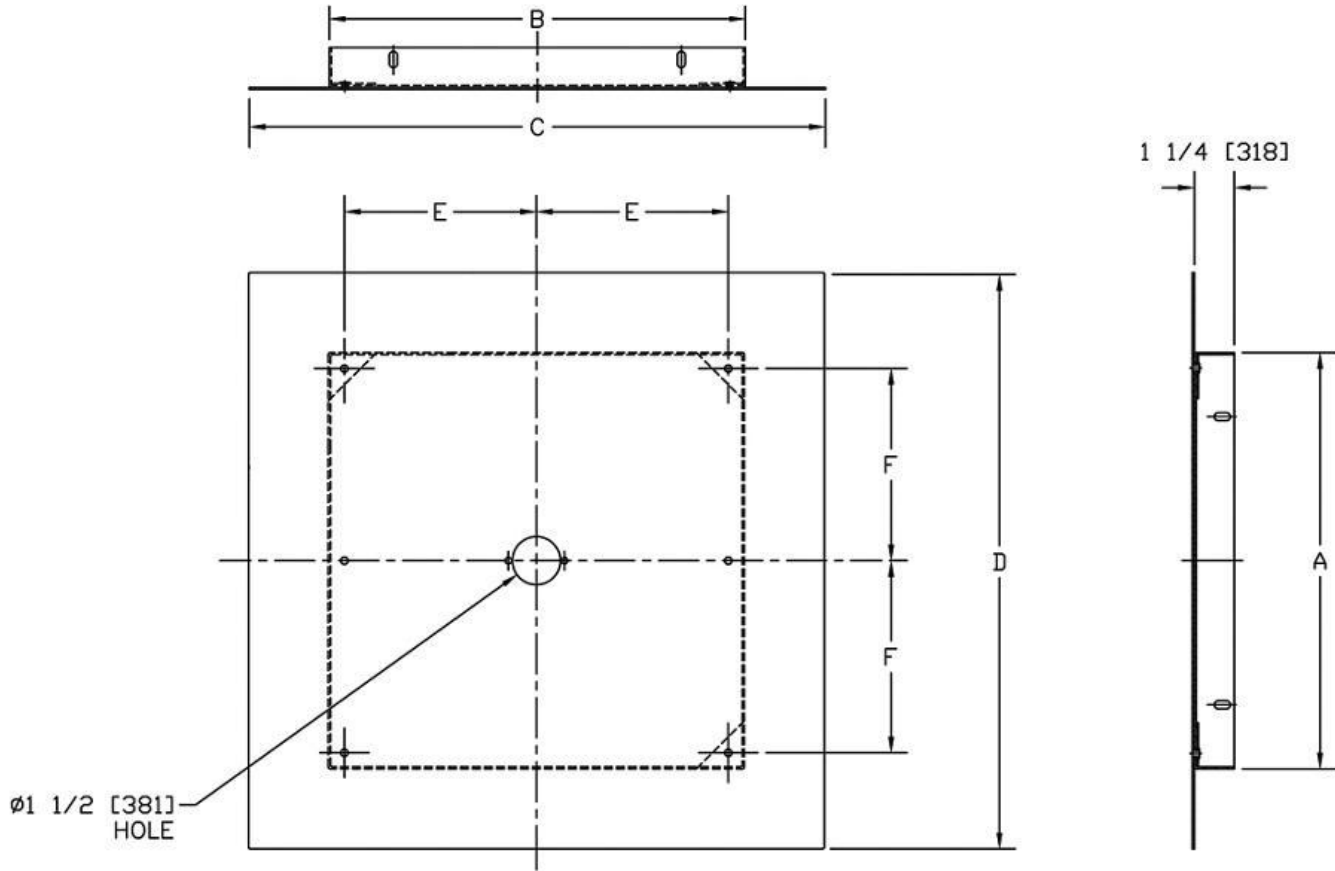

PRODUCT NO.	SIZE	A	B	C	D	E	F
Z6199-BX12	12x12 [305x305]	12 [305]	12 [305]	13 1/2 [343]	13 1/2 [343]	5 1/2 [140]	5 1/2 [140]
Z6199-BX17	13x17 [330x432]	17 [432]	13 [330]	14 1/2 [368]	18 1/2 [470]	6 [152]	8 [203]

NOTE: All dimensions are for reference only. Do not use for pre-plumbing.